



HUAYI COMPRESSOR (JINGZHOU) CO., LTD.  
产品样本 PRODUCT SPECIFICATION 2018

型号 Model	电源 Power supply (V/Hz)	汽缸容积 Displacement (cm <sup>3</sup> )	制冷量 Cooling Capacity(W)	COP (W/W)	电机类型 Motor Type	认证 Certification
B Series						
B30C	220~240/50	3.1	50	1.05	RSIR	
	220~240/60		58	1.15	RSIR	
B35C	220~240/50	3.5	56	1.05	RSIR	CCC VDE CB
	220~240/60		63	1.20	RSIR	
	220~240/50		56	1.25	RSIR	
	220~240/60		63	1.35	RSIR	
	220~240/50		56	1.35	RSCR	
B35CA	220~240/50	3.5	56	1.35	RSCR	CCC VDE CB
B35C5B	110~115/60	3.5	65	1.25	RSIR	UL CUL
			65	1.35	RSIR	
B35C5BL	110~120/60	3.5	65	1.45	RSCR	UL CUL
B43CB	220~240/50	4.3	68	1.05	RSIR	CCC VDE CB
	220~240/60		78	1.15	RSIR	
	220~240/50		68	1.25	RSCR	
	220~240/60		78	1.35	RSCR	
	220~240/50		68	1.40	RSCR	
B43C0	100-50/60	4.3	78	1.25	RSIR	
B43C5B	110~115/60	4.3	78	1.25	RSIR	UL CUL
			78	1.35	RSIR	
B43C5B	127/60	4.3	78	1.30	RSIR	CB
B43C5BL	110~120/60	4.3	78	1.45	RSCR	UL CUL
B52C	220~240/50	5.2	78	1.10	RSIR	CCC VDE CB
			78	1.25	RSIR	
			78	1.40	RSCR	
B52CL	220~240/50	5.2	78	1.25	RSIR	CCC VDE CB
	220~240/60		95	1.25	RSIR	
B52C5BL	110~120/60	5.2	95	1.40	RSCR	UL CUL
B52C0	100-50/60	5.2	95	1.25	RSIR	
B60CB	220~240/50	6.0	95	1.15	RSIR	CCC VDE CB
			95	1.25	RSIR	
			95	1.35	RSIR	
			95	1.45	RSCR	
B60CBL	220~240/50	6.0	95	1.30	RSIR	CCC VDE CB
			95	1.40	RSCR	
			95	1.55	RSCR	
B60C5BL	220~240/60	6.0	110	1.40	RSIR	CCC VDE
	110~120/60		110	1.30	RSIR	
B60C7L	127/60	6.0	110	1.40	RSCR	UL CUL
			110	1.35	RSIR	
B65CL	220~240/50	6.5	100	1.25	RSIR	
			100	1.45	RSCR	
L Series						



HUAYI COMPRESSOR (JINGZHOU) CO., LTD.  
产品样本 PRODUCT SPECIFICATION 2018

L22CL	220~240/50	2.2	30	0.85	RSIR	CCC VDE CB
L22C5L	110-120/60	2.2	40	1.20	RSIR	UL CUL
L30CL	220-240~50	3.1	50	1.10	RSIR	CCC CB
	220-240~60		55	1.20	RSIR	
L35CL	220~240/50	3.5	55	1.00	RSIR	CCC VDE CB
			55	1.15	RSIR	
			55	1.25	RSCR	
L35C5L	110-120/60	3.5	65	1.25	RSIR	UL CUL
			65	1.40	RSCR	
L35C0L	100-50/60	3.1	60	1.25	RSIR	
L35C7L	127/60	3.5	65	1.25	RSIR	CB
L40CL	220~240/50	4.0	65	1.10	RSIR	
L40C5L	110-120/60	4.0	78	1.30	RSIR	
L48C5L	110-120/60	4.8	75	1.00	RSIR	UL CUL
L52CL	220~240/50	5.2	67	0.90	RSIR	CCC VDE CB
L60CL	220~240/50	6.0	95	1.15	RSIR	
F Series						
F60CL	220~240/50	6.0	100	1.60	RSCR	
F70CL	220~240/50	7.0	115	1.20	RSIR	
			115	1.60	RSCR	
F80CL	220~240/50	7.9	135	1.25	RSIR	
			135	1.60	RSCR	
F80C5L	110-120/60	7.9	145	1.20	RSIR	
			145	1.70	RSCR	
F85CL	220~240/50	8.5	145	1.25	RSIR	
			145	1.40	RSIR	
			145	1.60	RSCR	
*F90CL	220~240/50	9.0	155	1.35	RSIR	
K Series						
K35CAL	220~240/50	3.5	55	1.60	RSCR	
K35C5BL	110-120/60	3.5	65	1.50	RSCR	
K43C0L	100-50/60	4.3	80	1.50	RSCR	
K43C5BL	110-120/60	4.3	80	1.50	RSCR	
K52C0L	100-50/60	5.2	95	1.50	RSCR	
K52C5BL	110-120/60	5.2	95	1.50	RSCR	
			95	1.10	RSIR	
K60CL	220~240/50	6.0	95	1.40	RSIR	
			95	1.60	RSCR	
K60CBL	220~240/50	6.0	95	1.60	RSCR	
	220/60		110	1.60	RSCR	
K60C5BL	110-120/60	6.0	110	1.60	RSCR	
K60C7L	127V/60	6.0	110	1.60	RSCR	
K65CL	220~240/50	6.5	110	1.15	RSIR	
			110	1.60	RSCR	

“\*” 标识表示待开发产品，“……” 标识表示认证中项目。

测试工况 Test conditions	按ASHRAE 标准According to ASHRAE
蒸发温度Evaporating temperature	-23.3℃
冷凝温度Condensing temperature	54.4℃



HUAYI COMPRESSOR (JINGZHOU) CO., LTD.  
产品样本 PRODUCT SPECIFICATION 2018

过冷温度Subcooling temperature	32.2℃
吸气温度Suction temperature	32.2℃
环境温度Ambient temperature	32.2℃

使用工况范围及极限Working condition limit:R600a

最大环境温度Max ambient temperature	43[℃]
蒸发温度范围Evaporation temperature range	-35~-15[℃]
工作电压范围Working voltage range	187~242[V]
最大排气压力Max discharge pressure	0.98[Mpa] (表压 gauge pressure)
最大允许壳温Max allowable housing temperature	95[℃]
最大排气温度Max discharge temperature	130[℃]
机壳最大承受压力max pressure housing endured	3.5 [Mpa] (表压 gauge pressure)
低电压启动性能 Low voltage start	0.25/0.25Mpa(表压 gauge pressure) 187V

1.3 R134a - HBP

型号 Model	电源 Power supply (V/Hz)	汽缸容积 Displacement (cm <sup>3</sup> )	制冷量 Cooling Capacity(W)	COP (W/W)	电机类型 Motor Type	认证 Certification
<b>B Series</b>						
B22G	220~240/50	2.2	185	1.80	RSIR	
B22G5	110~115/60	2.2	225	1.80	RSIR	
B25G	220~240/50	2.6	220	1.80	RSIR	
B25G5	110~115/60	2.6	265	1.80	RSIR	
B25G5L	110~120/60	2.6	265	2.00	CSIR	UL & CUL
B30G	220~240/50	3.1	260	1.80	RSIR/CSIR	VDE
	220~240/60	3.1	300	1.90	RSIR/CSIR	
B30G5	110~115/60	3.1	315	1.80	RSIR	
B35G5	110~120/60	3.5	360	2.00	CSIR	
B38G	220~240/50	3.8	350	2.10	CSIR	CCC VDE CE
B38G5L	110~120/60	3.8	420	2.10	CSIR	UL & CUL
B43GL	220~240/50	4.3	400	1.80	RSIR	CCC CB VDE
<b>F Series</b>						
F60GL	220~240/50	6.0	590	2.50	RSCR	
F70GL	220~240/50	7.0	700	2.50	RSCR	

测试工况 Test conditions	按ASHRAE 标准According to ASHRAE
蒸发温度Evaporating temperature	7.2℃
冷凝温度Condensing temperature	54.4℃
过冷温度Subcooling temperature	46.1℃
吸气温度Suction temperature	35℃
环境温度Ambient temperature	35℃



HUAYI COMPRESSOR (JINGZHOU) CO., LTD.  
产品样本 PRODUCT SPECIFICATION 2018

B35BU				
B43U				
B43BU				
B25G5L	155 ± 2.5	φ 6.1 ~ φ 6.2	φ 6.1 ~ φ 6.2	φ 4.9 ~ φ 5.0
B38G5L				
B60C7L				
B30N	159 ± 2.5			
B43GL				
B65CL				
S——吸气管 Suction tube		吸气管和工艺管可以互换		
P——工艺管 Process tube		Connections on suction and process		
D——排气管 Discharge tube		can be inverted		

2.2 L 系列

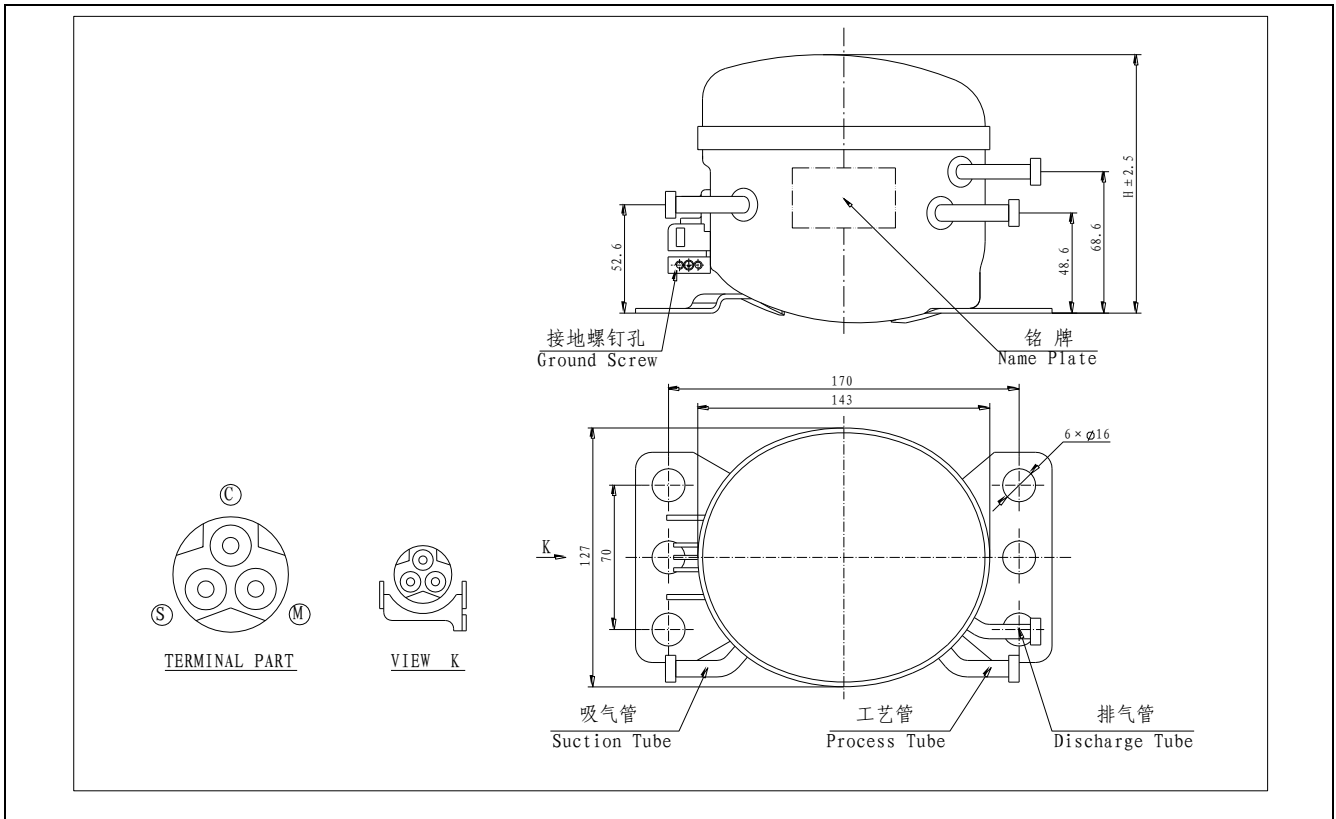

壳体高度和管径 Housing height and dimension

型号 Model	压缩机高度 Height (mm)			
	H	连接铜管内径 Tube internal diameter (mm)		
		S	P	D
L22HL	125 ± 2.5	φ 6.1 ~ φ 6.2	φ 6.1 ~ φ 6.2	φ 4.9 ~ φ 5.0
L22CL				
L22H5				
L22H5L				
L22H7L				
L25H				
L25H5				
L22C5L				



L25H5L	<b>129 ± 2.5</b>			
L30CL				
L48C5L				
L52CL				
L30HL				
L30H				
L30H5L				
L30H5				
<b>L35CL</b>				
L35C5L				
L35C0L				
L35C7L				
L40CL				
L40C5L				
L60CL	<b>141 ± 2.5</b>			
S——吸气管 Suction tube		吸气管和工艺管可以互换		
P——工艺管 Process tube		Connections on suction and process		
D——排气管 Discharge tube		can be inverted		

### 2.3 F 系列

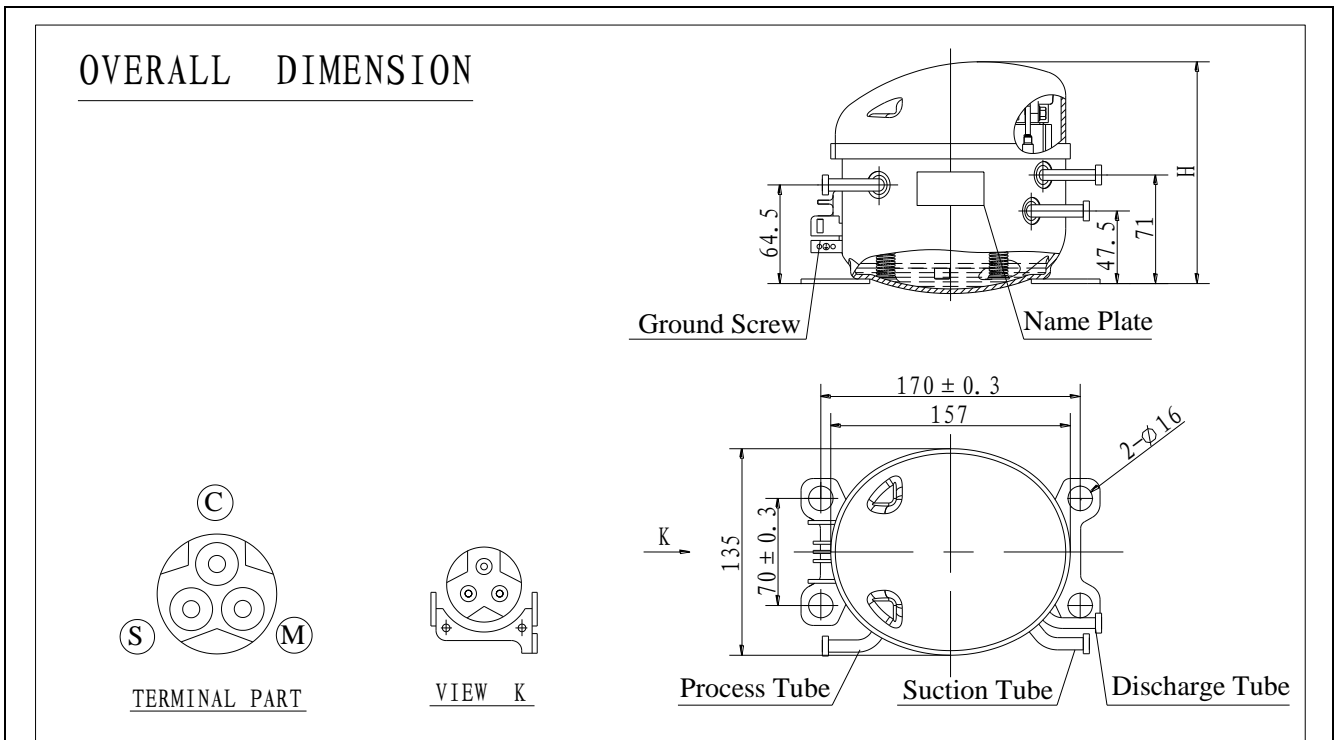

壳体高度和管径 Housing height and dimension

型号 Model	压缩机高度 Height (mm)			
	H	连接铜管内径 Tube internal diameter (mm)		
		S	P	D
F52HL	<b>145 ± 2.5</b>	$\phi 6.1 \sim \phi 6.2$	$\phi 6.1 \sim \phi 6.2$	$\phi 4.9 \sim \phi 5.0$
F60CL				
F70CL				

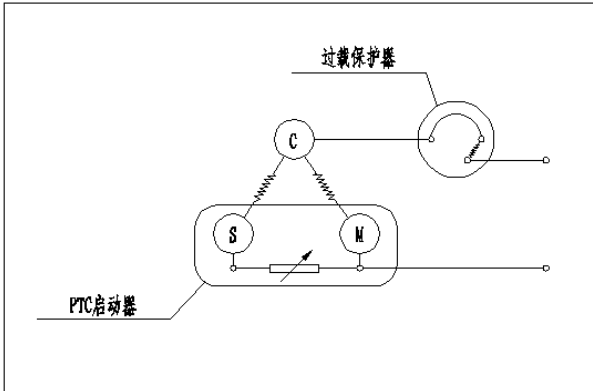
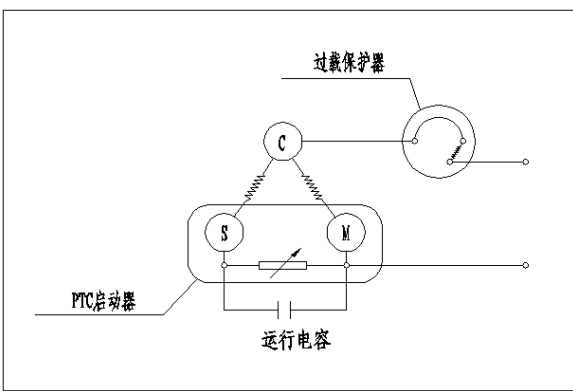
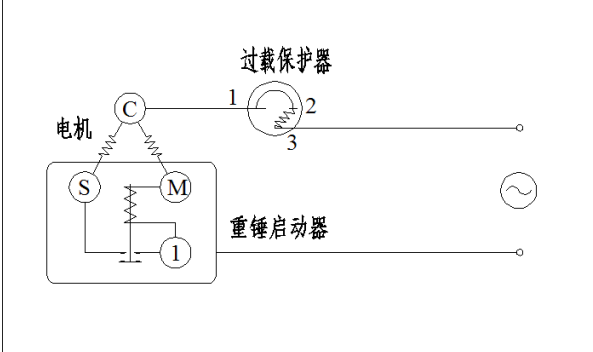
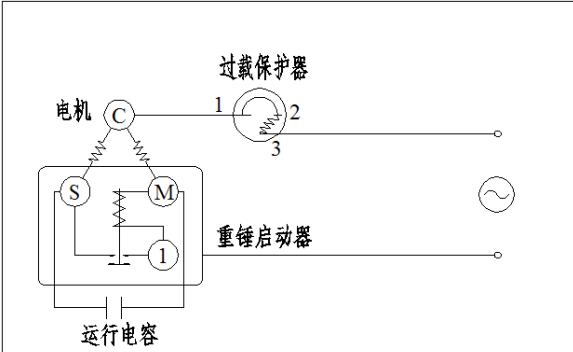
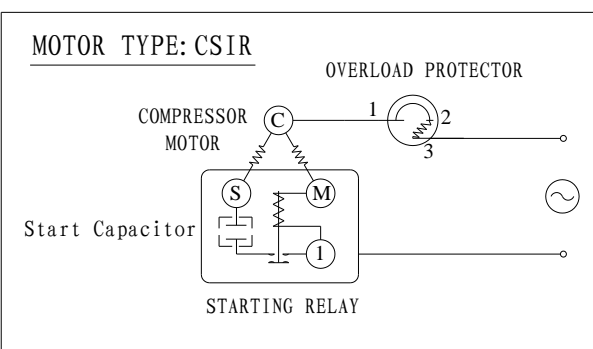
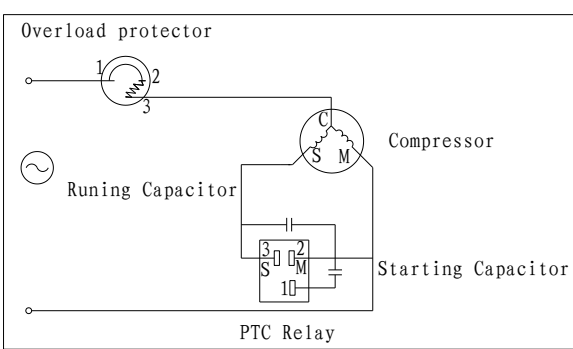
	
<p>RSIR (重锤启动器)</p>	<p>RSCR (重锤启动器)</p>
	
<p>CSIR (重锤启动器)</p>	<p>CSR (PTC 启动器)</p>
<p>MOTOR TYPE: CSIR</p> 	
<p>C—公共 Commom                      S—启动 Start                      M—运行 Run</p>	

#### 4、使用注意事项Attention Items

4.1 请遵从包装箱上的运输警告，装卸过程中切勿翻滚包装箱。

Please follow the transportation warning marks on the package for layer limitation. Do not roll the whole packages when loading or unloading.

4.2 运输过程中请始终保持压缩机垂直，不能倒置，并尽量避免碰撞和振动。

Please keep the compressor always vertically and never upset it during transportation



while avoiding any vibration and shock.

4.3 摔过的压缩机不能保证能正常工作。

Tumbled compressor cannot be guaranteed for norm operation.

4.4 压缩机存储期限为从生产日前开始的 6 个月，如果超过期限，请检查压缩机内的氮气压力，必要时重新充灌。

Storage expiry is 6 months from the date of production. If it expired, please check the nitrogen pressure inside compressor and recharge it when it is necessary.

4.5 拔出橡皮塞后，请在 5 分钟内将压缩机与制冷系统连接，建议先从排气管拔橡皮塞。

After pulling off rubber plugs from the compressor tubes, please connect the compressor to the refrigeration system within 5minutes. It is advisable to take off the first plug from discharge tube.

4.6 真空状态下压缩机不得加高电压测试或进行启动测试。

High voltage test or start test is not permitted under vacuum condition.

4.7 避免液态制冷剂回流压缩机。

Avoid liquid refrigerant flow into the compressor.

4.8 压缩机接地线应永久牢固的接地。

The earth connection should be fixed firmly.

4.9 压缩机运转时应保持水平，最大允许的倾斜角度为 5° 。

The compressor must be mounted horizontally without tilting an angle more than 5.

4.10 压缩机停机后必须间隔 5 分钟才能再次启动。

The compressor must not be restarted unless at an interval of more than 5 minutes.

4.11 压缩机不得使用防冻剂和其它非规定油品。

Antifreeze and other unspecified oil is not allowed to use in compressor.

## 5、接线示意图 Accessories and Assembly

### 5.1 RSIR 方式接线示意图

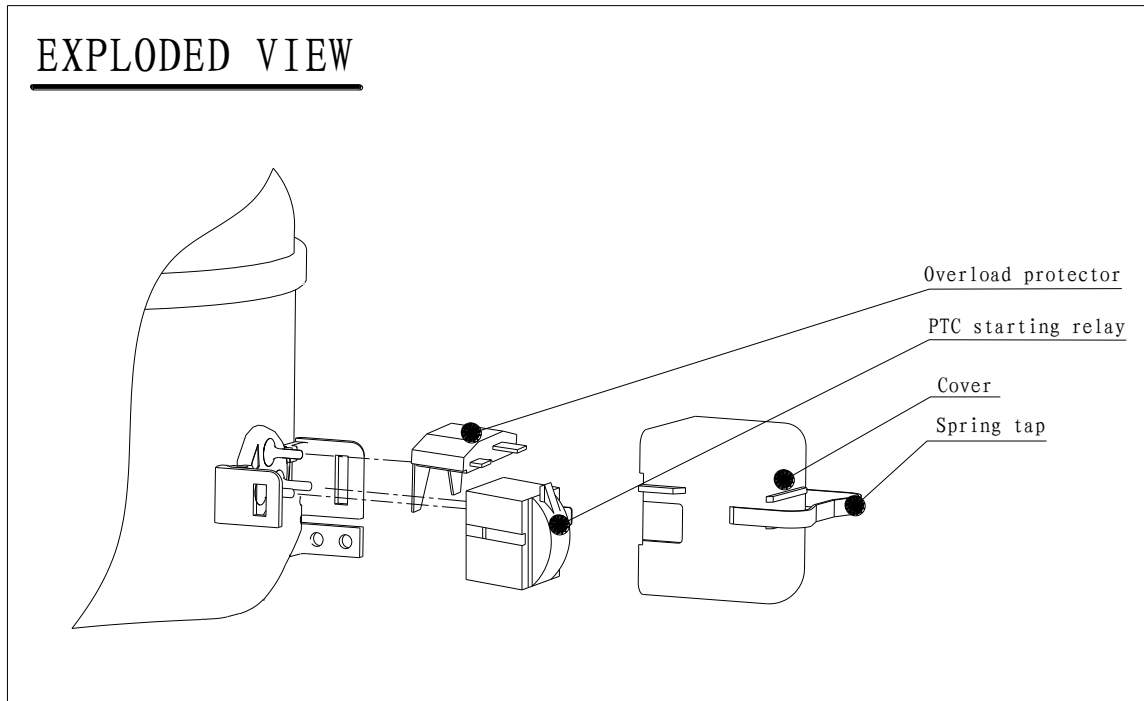

### 5.2 RSCR 方式接线示意图

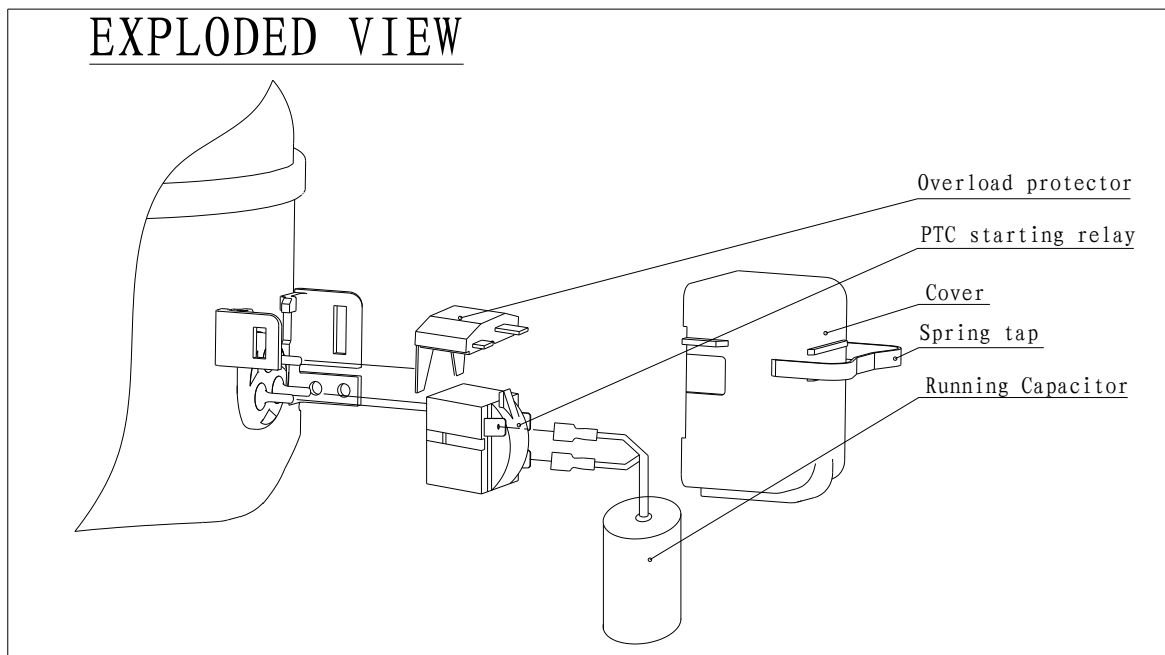

5.3 CSIR 方式接线示意图

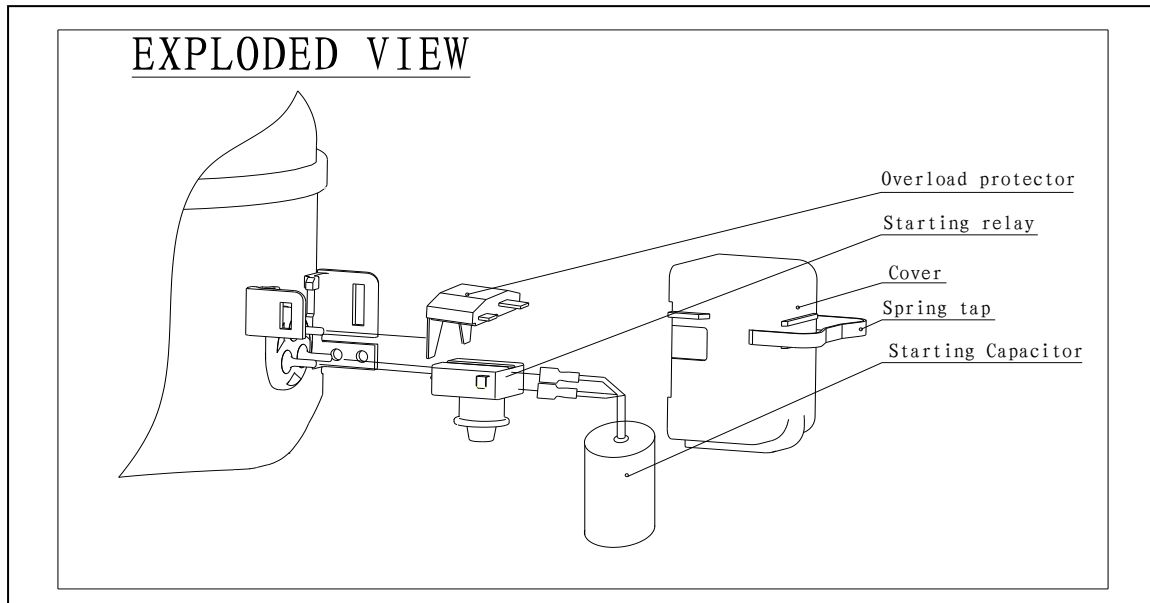

5.4 RSCR 方式接线示意图（重锤启动器）

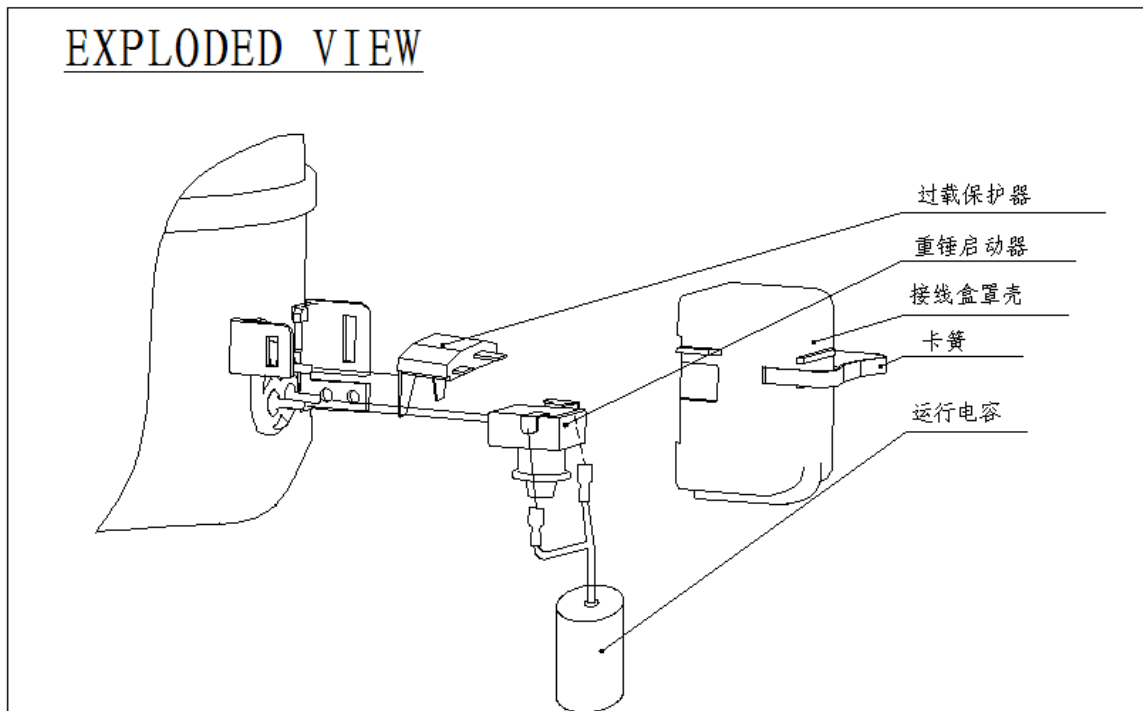

5.5 机械温控模式接线图（直流变频）

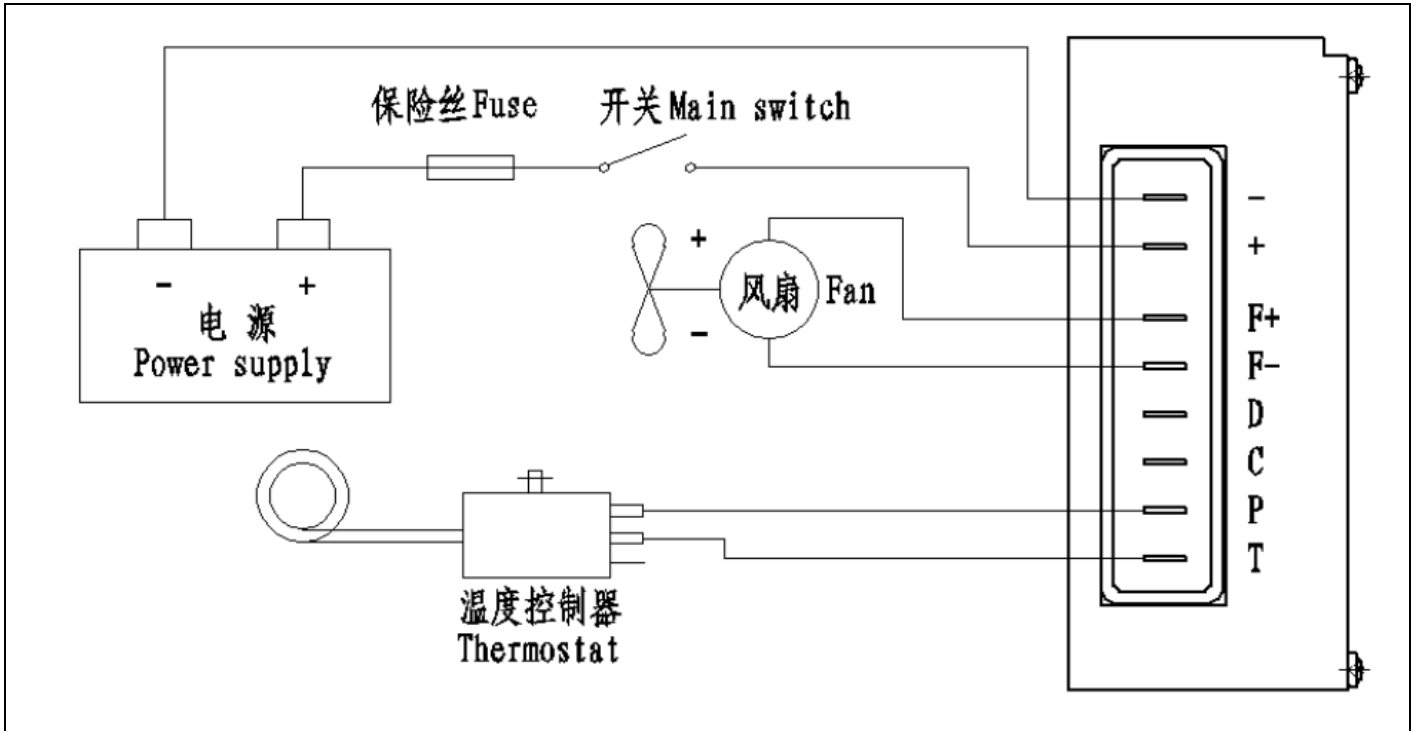

5.6 电子通讯模式接线图（直流变频）

